

DO NOT SCALE FROM THIS DRAWING
All dimensions to be verified on site

- NOTES**
- All signs as per chapter 8. Distances between cones on a 30mph carriageway to be 5m minimum 9m maximum unless otherwise noted.
 - All works / traffic management shall be in accordance with the traffic signs manual chapter 8, Safety at street works and road works a code of practice 2013, Traffic Signs Regulations and General Directions.
 - Minimum no. hazard lamps: 9 per 6m hazard width.
 - Distances between signs NOT to scale for purpose of clarity.
 - Minimum sign size 750mm.
 - Absolute Minimum 3.0m running lane width to be maintained.

LEGEND

	WORKS AREA		ASPECT OF SIGN VISION
	TRAFFIC CONES		BARRIER
	3X		2X
	1X		3X
	1X		2X
	1X		1X

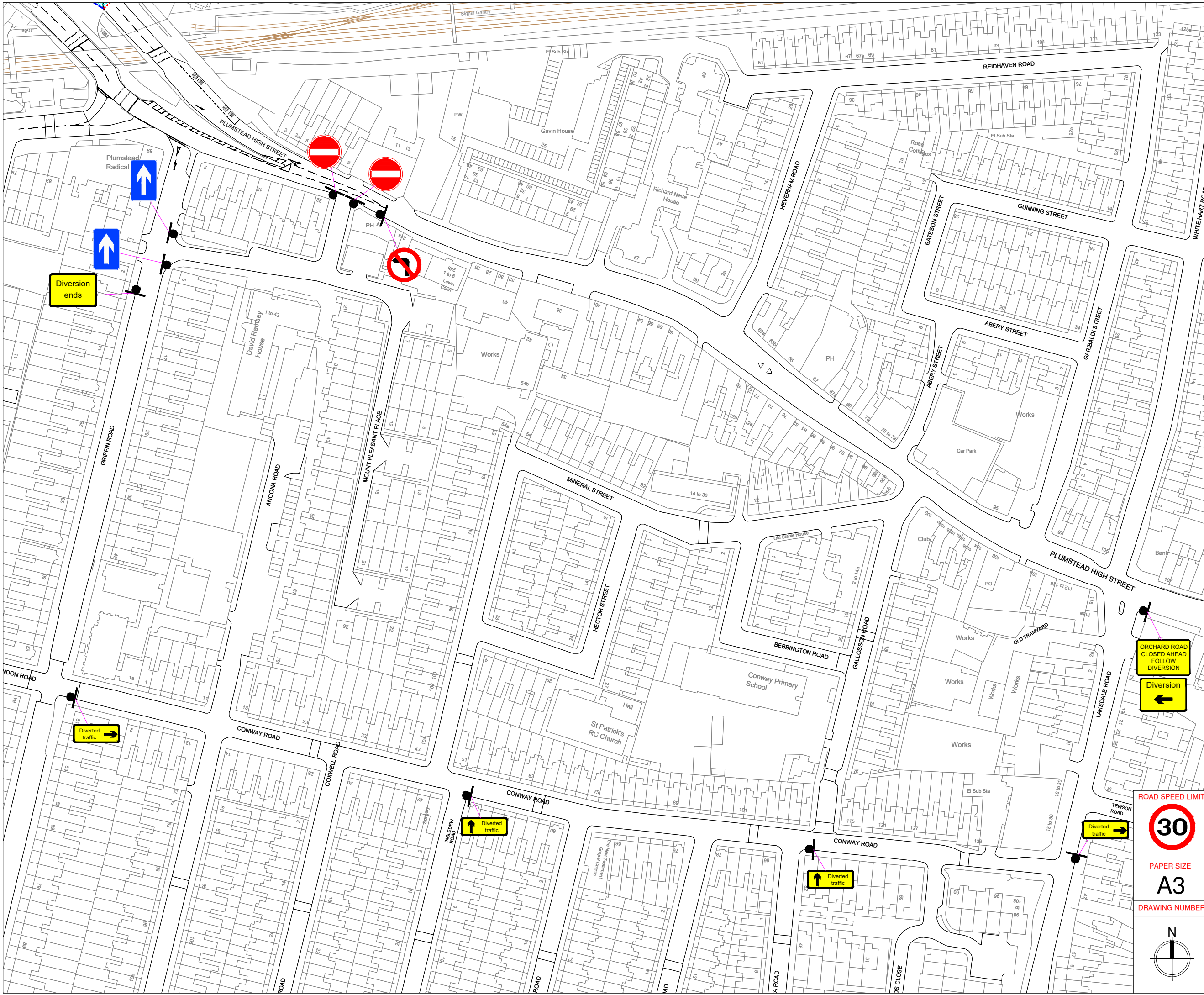

ROAD SPEED LIMIT

PAPER SIZE

A3

DRAWING NUMBER

MTS-PETTMAN CRESCENT-SE28-CONTRAFLOW-JBR-004A

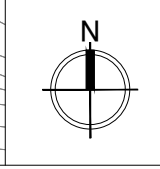

PRODUCED ON BEHALF OF

RINEY

metro Unit N6 Lympe Ind Est,
Kent CT21 4LR
traffic services ltd t: 01303 265700

DRAWN BY PMM **DRAWN DATE** 07/06/23

DRAWING TITLE PETTMAN CRESCENT DIVERSION

REVISION No.	-	REVISION DATE	-
COMMENTS	DRAWN FOR CLIENT ISSUE/REVIEW		
REVISED BY	-	APPROVED BY	JS