

**DO NOT SCALE FROM THIS DRAWING**  
All dimensions to be verified on site

- NOTES**
- All signs as per chapter 8. Distances between cones on a 30mph carriageway to be 5m minimum 9m maximum unless otherwise noted.
  - All works / traffic management shall be in accordance with the traffic signs manual chapter 8, Safety at street works and road works a code of practice 2013, Traffic Signs Regulations and General Directions.
  - Minimum no. hazard lamps: 9 per 6m hazard width.
  - Distances between signs NOT to scale for purpose of clarity.
  - Minimum sign size 750mm.
  - Absolute Minimum 3.0m running lane width to be maintained.

**LEGEND**

	WORKS AREA		ASPECT OF SIGN VISION
	TRAFFIC CONES		BARRIER
	3x		6x PORTABLE SIGNAL HEAD
	1x		18x PEDESTRIAN CONTROLLED CROSSING
	8x		5x RAMPS
	1x		1x
	3x		4x
	6x		1x
	PEDESTRIANS 1x		CROSSING NOT IN USE 2X
	PEDESTRIANS 1x		

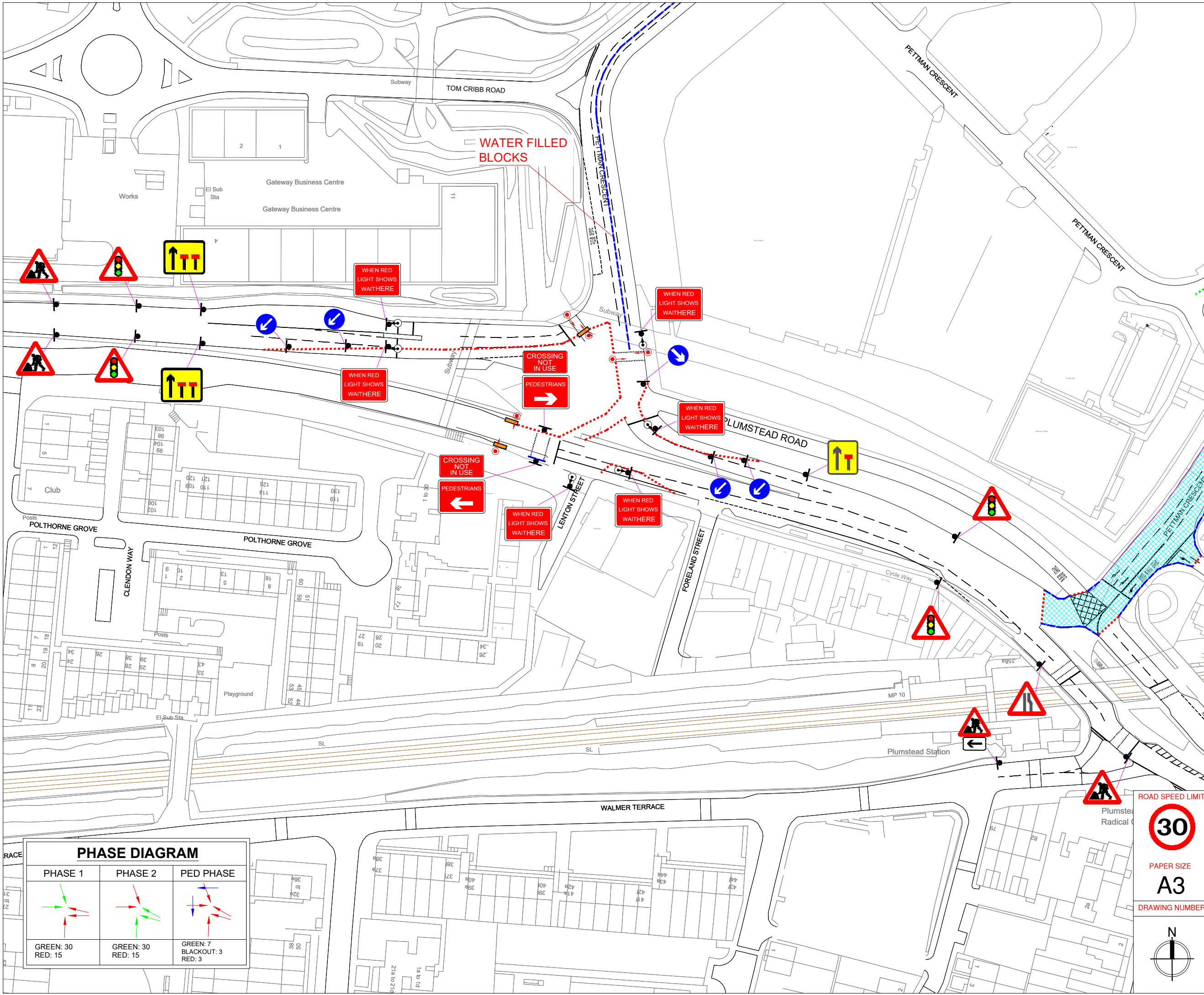

**PHASE DIAGRAM**

PHASE 1	PHASE 2	PED PHASE
GREEN: 30 RED: 15	GREEN: 30 RED: 15	GREEN: 7 BLACKOUT: 3 RED: 3

ROAD SPEED LIMIT

PAPER SIZE **A3**

DRAWING NUMBER

PRODUCED ON BEHALF OF

**RINEY**

**metro** Unit N6 Lympe Ind Est, Kent CT21 4LR  
traffic services ltd t: 01303 265700

DRAWN BY PMM DRAWN DATE 07/05/23

DRAWING TITLE MTS-PETTMAN CRESCENT-SE28-CONTRAFLOW-JBR-002

REVISION No. 1 REVISION DATE 27/06/23

COMMENTS DRAWN FOR CLIENT ISSUE/REVIEW

REVISED BY PMM APPROVED BY JS